

WASP-N

User Manual

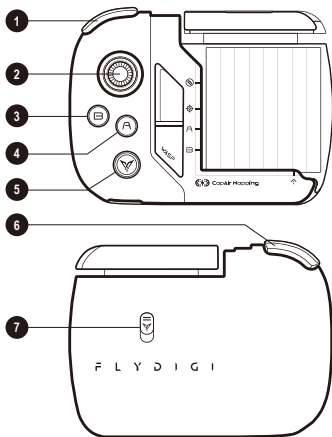

1 LB Button

2 Joystick

3 B Button

4 A Button

5 Logo Button

6 LT Button

7 Lock

Using Wasp

1. Turn on Wasp by sliding the switch to the left.
The light will become orange.

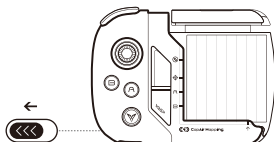

-
2. Pull down the switch on the back of the gamepad.
The yellow handle will pop up.

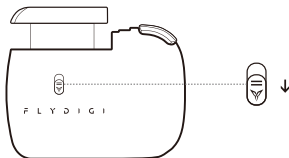

3. Turn off the portrait orientation lock on your iPhone.



Turn off
portrait orientation lock



-
4. Lock your screen (make sure your screen comes blank) and plug your iPhone into Wasp as shown.

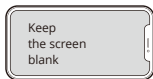

5. Press the yellow handle until your iPhone is secured.

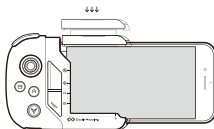

6. Unlock your iPhone.

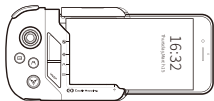

- Wasp-N version supports iPhone 6 - 8 and iPhone 6 P- 8 P.
- Make sure your screen is blank before plug your iPhone into WASP, otherwise you need to repeat steps 4 to 6.
- Wasp will enter sleep mode if no further action is taken within 10 minutes. Press Logo button once to turn on Wasp again.

Playing Games

With Wasp, you can directly control the game which is downloaded from App Store. The intersection of X and Y axis is the fixed projection point as shown below. Every button of Wasp has its own point. Drag an icon (e.g. shooting, aiming) in the game to any point, then you have established the connection with button and icon. The mapping ruler can help you locate more precisely.

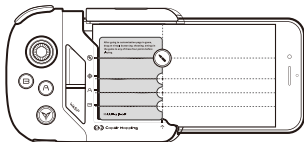

Take Fortnite as an example. Go to 'HUD Layout tool' in game. Drag the virtual button to the corresponding mapping location mentioned above. The button of gamepad is now mapped to the virtual button.

1. Only the Left Trigger supports long pressing. Any virtual button that needs long pressing should be set to where Left Trigger is.
2. All mobile FPS games (such as Fortnite & PUBG Mobile) support customization of buttons. For games that do not support customization of buttons, joystick control can be used.

Wasp Lighting Extension

Flydigi Wasp Lightning Extension is special extension cable for iPhone. It allows you to use a headphone or charge your iPhone while using Wasp

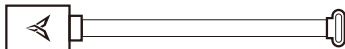

1. Plug iPhone lightning cable into Wasp Lightning Extension



-
2. Plug Wasp Lightning Extension into your iPhone



3. Install your iPhone into Wasp

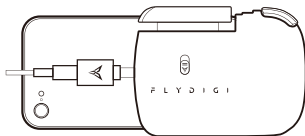

4. Plug the lightning cable into portable power bank.

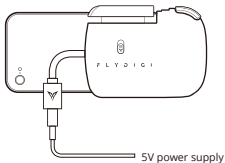

1. Please follow the instructions step by step in order to have you iPhone charged correctly.
2. While using a headphone, please plug your headphone into Wasp Lighting Extension first.

Basic Operation and Indicator Light Description

Turn On/Off	Slide the power button to the left	Green light blinks twice
	Slide the power button to the right	
Operation	After Wasp is turned on	Light becomes orange
Activate Wasp	Press Logo button once	Light becomes orange
Charging	During charging	Light becomes red
	Charging is completed	Red light turns off
Low Battery Status	When battery is below 20%	Green light blinks slowly
	When battery is below 10%	Green light blinks fast

Adjust Joystick	Press Logo button and LB button for 3 seconds	Green light blinks twice slowly
Switch Joystick Mode	Press Logo button for 3 seconds	Orange light blinks once, joystick enters FPS mode
		Orange light blinks twice, joystick enters MOBA mode

Model No: Wasp-N

Compatibility: iPhone 6-8 & 6-8Plus

Connection: CapAir Mapping; Bluetooth 4.0

Dimensions: 110*81*19 mm

Weight: 100g

Battery Capacity: 300mAh

Charging Info: 5V/100mA

Charging Time: 2 hours

Standing Time: 15 hours

Operating Current: <20mA

Operating Environment: 0 °C - 40 °C

FAQ

1 Wasp stops working with your iPhone in it

Ensure the top handle is fastened and capacitive bar covers your phone screen. We suggest to use a thinner phone case or take the phone out of the case while using Wasp.

2 Buttons fail to work while gaming

Turn off the screen before putting the phone into Wasp. This could help to avoid inaccurate capacitive sensing or interference during gaming.

3 Buttons fail to work while charging the phone

Using a portable power bank for charging is suggested to solve capacitive interference.

4 Earphones fail to work while using the Wasp Cable

Connect earphones with Wasp Cable first, then plug Wasp Cable into the phone.

Upgrade Wasp

Wasp is now operating with the latest firmware version. We will keep you informed regarding newer versions when ready. Please visit www.flydigi.com to download upgrade tool.

More Information

We hope this user manual answered any questions you may have had, If you have any further questions, please contact us:

Facebook	https://www.facebook.com/Flydigi
Twitter	https://twitter.com/myFlydigi
For more support	http://www.flydigi.com